

INTRODUCTION

The TYPHOON Wizard is a mini GPS tracking device that gives you full one-handed flight control over the TYPHOON aircraft. Features such as 'Follow Me' and 'Watch Me' ensure that you are in frame in every shot. The 'Point to Fly' function allows you to point and click to reposition your TYPHOON in a very intuitive way.

SPECIFICATIONS

Dimensions	139 X 37 X 25 mm (5.47 X 1.46 X 0.98 in)
Weight (with LiPo Battery)	71.5 g (2.52 oz)
Compatible Aircraft	TYPHOON Q500 / Q500+ / Q500 4K / Black / G
Compatible Camera	CGO2GB / CGO2+ / CGO3
Water Resistant	Yes
Working Hours	3.5 h
Built-in LiPo Battery Voltage / Capacity	3.7V 500mAh

NOTICES AND WARNINGS

1. The Wizard CANNOT replace the Personal Ground Station/Remote Controller because it has no Wifi.
2. Do not submerge the Wizard in water no matter it is in/not in waterproof carrying strap. The aircraft will lose signal.
3. Do not use Home Mode when you are in water areas.
4. Be sure to turn off the Wizard when you do not use it.
5. Be sure to operate the Wizard in open areas that are free from people, vehicles and other obstructions. Never fly near or above crowds, airports or buildings.

GENERAL SAFETY PRECAUTIONS AND WARNINGS

- Failure to use this product in the intended manner as described in instruction manual can result in damage to the product, property and/or cause serious injury. This product is not a toy! If misused it can cause serious body harm and damage to property.
- As the user of this product you are solely and wholly responsible for operating it in a manner that does not endanger yourself and others or result in damage to the product or the property of others.
- Do not attempt to operate your equipment in areas with potential magnetic and/or radio interference including areas nearby broadcast towers, power transmission stations, high voltage power lines, etc.

OVERVIEW

1. Aircraft Mode LED
2. Wizard GPS LED
3. Aircraft Status LED
4. Ascend / Forward Button
5. Turn / Fly to the Left Side Button
6. Turn / Fly to the Right Side Button
7. Descend / Backward Button
8. Magic Button
9. Pitch Control Button-down
10. Pitch Control Button-up
11. Start / Stop Motors Button
12. Wizard Power Button
13. Wizard Power LED
14. Smart / Angle / Home Mode Switch
15. Clip
16. USB Port

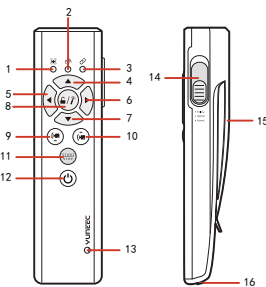

WIZARD LED STATUS:

Aircraft Mode LED

- Smart Mode: LED solid green
- Angle Mode: LED solid purple
- Home Mode: LED solid red
- 'Point To Fly' Function Activated: LED solid blue

Wizard GPS LED

- GPS Locked: LED solid green.

Aircraft Status LED

- The Communication Mal-function Between the Wizard and the Aircraft : LED solid red
- GPS Loss of Aircraft: LED off
- Aircraft in No-Fly Zone: LED blinking red, green and blue alternately
- Battery full: LED solid green
- Battery 50%: LED blinking green twice every 2 seconds
- Battery 25%: LED blinking green once every 2 seconds
- Low Voltage Warning of the Aircraft: LED blinking red quickly, the Wizard vibrating for 2 seconds once continuously

Wizard Power LED:

- Powered On: LED solid green
- During Charging: LED solid red
- Charging Completed: Red LED off
- Low Voltage Warning of the Wizard: LED blinking green twice every 2 seconds
- Low Voltage--- LED blinking green once every 2 seconds
- Power Cut-off---LED blinking red quickly, the Wizard vibrating for 2 seconds once continuously.

BATTERY WARNINGS AND USAGE GUIDELINES

WARNING: Lithium Polymer (LiPo) batteries are significantly more volatile than alkaline, NiCd or NiMH batteries. All instructions and warnings must be followed exactly to prevent property damage and/or serious injury as the mishandling of LiPo batteries can result in fire. By handling, charging or using the included LiPo battery you assume all risks associated with LiPo batteries. If you do not agree with these conditions please return the complete product in new, unused condition to the place of purchase immediately.

- You must always charge the LiPo battery in a safe, well-ventilated area away from flammable materials.
- Never charge the LiPo battery unattended at any time. When charging the battery you must always remain in constant observation to monitor the charging process and react immediately to any potential problems that may occur.
- After flying/discharging the LiPo battery you must allow it to cool to ambient/room temperature before recharging.
- To charge the LiPo battery you must use only the included charger or a suitably compatible LiPo battery charger. Failure to do so may result in a fire causing property damage and/or serious injury.
- If at any time the LiPo battery begins to balloon or swell, discontinue charging or discharging immediately. Quickly and safely disconnect the battery, then place it in a safe, open area away from flammable materials to observe it for at least 15 minutes, continuing to charge or discharge a battery that has begun to balloon or swell can result in a fire. A battery that has ballooned or swollen even a small amount must be removed from service completely.
- Do not over-charge the LiPo battery. Discharging the battery too low can cause damage to the battery resulting in reduced power, flight duration or failure of the battery entirely. LiPo cells should not be discharged to below 3.0V each under load.
- Store the LiPo battery at room temperature and in a dry area for best results.
- When charging, transporting or temporarily storing the LiPo battery the temperature range should be from approximately 40°-120° F (5°-49°C). Do not store the battery or aircraft in a hot garage, car or direct sunlight. If stored in a hot garage or car the battery can be damaged or even catch fire.
- Never leave batteries, chargers and power supplies unattended during use.
- Never attempt to charge low voltage, ballooned/swollen, damaged or wet batteries.
- Never allow children under 14 years of age to charge batteries.
- Never charge a battery if any of the wire leads have been damaged or shorted.
- Never attempt to disassemble the battery, charger or power supply.
- Never drop batteries, chargers or power supplies.
- Always inspect the battery, charger and power supply before charging.
- Always ensure correct polarity before connecting batteries, chargers and power supplies.
- Always disconnect the battery after charging.
- Always terminate all processes if the battery, charger or power supply malfunctions.

IMPORTANT NOTE: It's safer and better for the longevity of the battery to store it only partially charged for any length of time. Storing the battery approximately 50% charged (which is around 3.85V per cell) is typically best, however, it will take some careful management of the charge time and the use of a volt meter to achieve this voltage. If you have the equipment and skills to achieve the 50% charge level for storage it is recommended. If not, simply be sure to not store the battery fully charged whenever possible. In fact, as long as the battery will be stored at approximately room temperature and for no more than a few weeks before the next use, it may be best to store the battery in the discharged state after the last flight (as long as the battery was not over-discharged on the last flight).

CHARGING THE BATTERIES

You can charge the LiPo battery installed in the TYPHOON Wizard from a computer using the USB. While the TYPHOON Wizard is powered off, connect the cable to a computer. The Power LED will be solid red while the battery is charging, and will be off when the battery is fully charged. It will take approximately 2 hours to charge a fully discharged (not over-discharged) battery, and its working hours is 3.5 h.

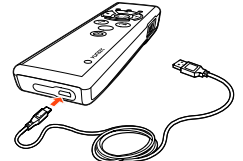

WARNING: Do not take out the LiPo battery installed in the TYPHOON Wizard, otherwise the TYPHOON Wizard may be damaged.

TYPHOON WIZARD AND RECEIVER BINDING:

NOTICE: If it is your first time to use the TYPHOON Wizard to control an aircraft, please bind the TYPHOON Wizard to your aircraft.

Step 1) Ⓐ Turn on the aircraft. Ⓑ Lift its tail upwards approximately 45° then back down to level twice to put the aircraft/receiver into binding mode.

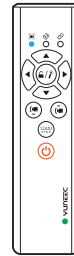
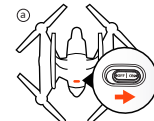

Step 2) Press and hold the Power Button till the Aircraft Mode LED glows solid blue. Shake the TYPHOON Wizard up and down till hearing two beeps from the aircraft. Release the Power Button.

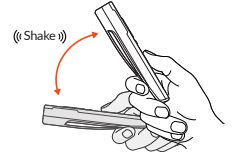

NOTICE: The TYPHOON Wizard only needs to be bound to an aircraft for the first time. There is no need to bind the Wizard to the same aircraft when you use it again.

POWERING ON/OFF:

Press and hold the Power Button Ⓐ. When all LEDs blink once and the TYPHOON Wizard vibrates once, release the Power Button Ⓐ. The Power LED glows solid green, and the Aircraft Mode LED is on, then the TYPHOON Wizard is powered on successfully.

NOTICE: Gyroscopes Mal-function: If the TYPHOON Wizard keeps vibrating when powering on and fails to power on, please return it to the service center for maintenance.

FLIGHT CONTROLS

NOTICE: The safe distance between the TYPHOON Wizard and the aircraft is 12m.

The TYPHOON Wizard can be controlled in different positions. Direction Control Buttons function differently according to the positions of the Wizard.

- 1) When the TYPHOON Wizard is tilted upwards between 50° and 90°, the functions of the Direction Control Buttons are as follows:
 - 90°
 - 50°
 - 0°
- 2) When the TYPHOON Wizard is tilted upwards between 0° and 40°, the functions of the Direction Control Buttons are as follows:
 - 90°
 - 40°
 - 0°

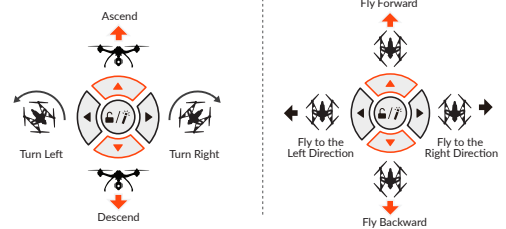

NOTICE: When the aircraft flies to the left or right side, the nose of aircraft doesn't change its direction.

'POINT TO FLY' FUNCTION

Press and hold the Magic Button on the TYPHOON Wizard, and the aircraft can fly to any direction the TYPHOON Wizard is pointed to in the sky.

To Enter 'Point To Fly' Function

Point the TYPHOON Wizard to a direction, press and hold the Magic Button. Release the Magic Button when Aircraft Mode LED glows solid blue and TYPHOON Wizard vibrates once. Then the aircraft will fly to the direction the TYPHOON Wizard points. The closer the TYPHOON Wizard is tilted towards 0°, the further the aircraft will fly away from the pilot. The closer the TYPHOON Wizard is tilted towards 90°, the closer the aircraft will fly to the pilot. When the Wizard is tilted at 90°, the aircraft will fly close to you straightly and stop at a safe distance.

NOTICE: The recommended flying height is 10-20 m. The operating distance range of the TYPHOON Wizard is 10-50 m.

- • • WIZARD Pointing Direction

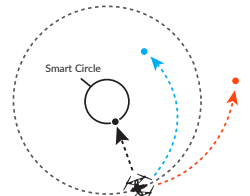

To Exit 'Point To Fly' Function

When in the 'Point To Fly' Function, press any Direction Control Button to exit this function. The aircraft will stop moving and automatically hold its position (with a suitable GPS signal/lock) and maintain a level attitude then.

FLIGHT MODES

SMART MODE

When the Flight Mode Selection Switch is in the top position, the aircraft will be in the Smart Mode. The Aircraft Mode LED will glow solid green.

1) Watch Me Function Under Smart Mode

Watch Me function enables the camera to keep tracking the TYPHOON Wizard no matter where and how it moves as the camera can automatically tilt its angle according to the controller. Usually, the default function under the Smart Mode is Watch Me.

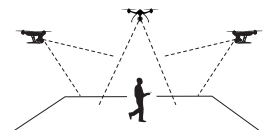

TYPHOON WIZARD

The Turn Left ◀ and Turn Right ▶ are disabled in this mode (Fly to the Left Direction and Fly to the Right Direction can be controlled). The pilot will always be kept in the frame wherever he moves.

NOTICE: In the Smart Mode, the geo-fence will keep the aircraft from traveling further than 300 feet (90meters). The geo-fence is a virtual 'barrier'.

CAUTION: Any operation related to camera control needs to be done on mobile APPs. The APP can be downloaded from Google Play Store or APP Store. You can't use the Wizard to take photos or record videos.

IMPORTANT NOTE: The 'Point To Fly' Function can only be activated in Smart Mode.

2) Follow Me Function Under Smart Mode

The Follow Me function allows the aircraft to follow the pilot, adjusting its location to the location of the TYPHOON Wizard. All buttons are controllable in this mode. When in Follow Me function, the aircraft will follow the movement of the TYPHOON Wizard if there is no extra operation on the TYPHOON Wizard.

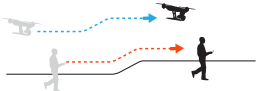

Follow Me function can be switched to by the following steps:

When in Smart Mode, press the Magic Button quickly once and the Aircraft Mode LED will glow solid yellow. And it will be in Follow Me function.

WARNING: The maximum flight speed of TYPHOON Q500 aircraft is 7m/s. If the movement of the pilot is much faster than 7m/s, the aircraft may fly away.

IMPORTANT NOTE: 'Fly away' is NOT covered under warranty.

ANGLE MODE

When the Flight Mode Selection Switch is in the middle position the aircraft will be in Angle Mode. The Aircraft Mode LED will be solid purple.

In this mode, the aircraft will move in the direction the TYPHOON Wizard is controlled relative to the front/nose of the aircraft. The aircraft has no function of Follow Me or Watch Me.

NOTICE: In this mode, the 'Point To Fly' Function can't be activated.

IMPORTANT NOTICE: In the Angle mode, the aircraft is not suggested travelling further than 656 feet (200 meters). The Wizard will keep vibrating when the aircraft travels further than 656 feet (200 meters).

HOME MODE

When the Flight Mode Selection Switch is in the bottom position, the aircraft will be in the Home Mode. The Aircraft Mode LED will be solid red. To exit the Home Mode, switch the Mode Switch to Angle/Smart Mode, then the aircraft will stop moving and automatically hold its position (with a suitable GPS signal/lock) and maintain a level attitude then.

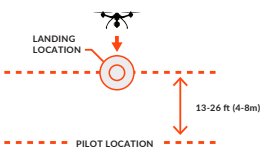

NOTICE: In this mode, the 'Point To Fly' Function can't be activated.

CAUTION: Don't switch to Home Mode when you are near water areas.

CAMERA CONTROLS

Any camera control including photo taking or video recording should be operated on Mobile Apps, which can be downloaded from Google Play Store or APP Store. The detailed information can be referred to relevant User Manuals on the official website: www.yuneeec.com



NOTICE: The control radius range of camera control is within 90 m.

CAUTION: When using the Wizard, if it keeps vibrating continuously, it indicates the hardware in the Wizard malfunction. Please send it to the official service center for maintenance.

FCC STATEMENT:

This equipment has been tested and found to comply with the limits for Part 15 of the FCC rules. These limits are designed to provide reasonable protection against harmful interference in a residential installation. This equipment generates, uses and can radiate radio frequency energy and, if not installed and used in accordance with the instructions, may cause harmful interference to radio communications.

However, there is no guarantee that interference will not occur in a particular installation. If this equipment does cause harmful interference to radio or television reception, which can be determined by turning the equipment off and on, the user is encouraged to try to correct the interference by one or more of the following measures:

- Reorient or relocate the receiving antenna.

- Increase the separation between the equipment and receiver.

- Connect the equipment to an outlet on a circuit different from that to which the receiver is connected.

This device complies with part 15 of the FCC rules. Operation is subject to the following two conditions: (1) This device may not cause harmful interference, and (2) this device must accept any interference received, including interference that may cause undesired operation.

NOTE: This equipment has been tested and found to comply with the limits for a Class B digital device, pursuant to part 15 of the FCC Rules. These limits are designed to provide reasonable protection against harmful interference in a residential installation. This equipment generates, uses and can radiate radio frequency energy and, if not installed and used in accordance with the instructions, may cause harmful interference to radio communications. However, there is no guarantee that interference will not occur in a particular installation. If this equipment does cause harmful interference to radio or television reception, which can be determined by turning the equipment off and on, the user is encouraged to try to correct the interference by one or more of the following measures:

- Reorient or relocate the receiving antenna.
- Increase the separation between the equipment and receiver.
- Connect the equipment into an outlet on a circuit different from that to which the receiver is connected.
- Consult the dealer or an experienced radio/TV technician for help.

CAUTION: Any changes or modifications not expressly approved by the party responsible for compliance could void the user's authority to operate this equipment.

IC RADIATION EXPOSURE STATEMENT FOR CANADA

This device complies with Industry Canada licence-exempt RSS standard(s).

Operation is subject to the following two conditions: (1) this device may not cause interference, and (2) this device must accept any interference, including interference that may cause undesired operation of the device.

Le présent appareil est conforme aux CNR d'Industrie Canada applicables aux appareils radio exempts de licence. L'exploitation est autorisée aux deux conditions suivantes : (1) l'appareil ne doit pas produire de brouillage, et (2) l'utilisateur de l'appareil doit accepter tout brouillage radioélectrique subi, même si le brouillage est susceptible d'en compromettre le fonctionnement.

This equipment complies with IC RSS-102 radiation exposure limit set forth for an uncontrolled environment.

Cet équipement respecte les limites d'exposition aux rayonnements IC définies pour un environnement non contrôlé

CUSTOMER SERVICE

<http://yuneeec.com/support>

YUNEEC USA
5555 Ontario Mills Parkway,
Ontario, CA91764, USA
1 855 2848888
sales@yuneeec.com

YUNEEC HK
2/F, Man Shung Industrial Building,
7 Lai Yip Street, Kwun Tong,
Kowloon, Hong Kong
852 3616 6071
asiasales@yuneeec.com

YUNEEC EU
Nikolaus-Otto-Strasse 4
24568 Kaltenkirchen, Germany
+49 4191 932620
eussales@yuneeec.com

YUNEEC AU
53 Ellemeesa Circuit, Lonsdale
South Australia 5160
+61 (0) 8 8186 3301
aussales@yuneeec.com

When the Aircraft Status LED is solid yellow or blinking yellow frequently, it indicates calibration is needed. Please refer to the TYPHOON Wizard User Manual from our official website: www.yuneeec.com

Any information above might be changed due to the software update. For the latest documents, please check the official website.

This device complies with part 15 of the FCC Rules. Operation is subject to the following two conditions: (1) This device may not cause harmful interference, and (2) this device must accept any interference received, including interference that may cause undesired operation.

